

← Push the HEPA filter cover button, open the cover and take out the HEPA filter for cleaning or replacement. Re-installing the HEPA filter is the reverse of the removal process. Be sure to close the HEPA cover and make sure it is sealed securely.
 Caution: the HEPA filter needs to be cleaned or replaced at least once a year.

4. trouble shooting

Problem	Cause	Solution
Motor will not start	1. The plug is not entirely plugged into the socket or the socket does not have electricity. 2. The switch is in the OFF position	1. Re-insert the plug into the socket or try another socket. 2. Turn on the power switch.
Suction is low	1. The dust bag is full. 2. The filter, hose, brush etc. is blocked.	1. Replace a new dust bag. 2. Clean the filter, hose, brush etc.

If the trouble still exists, please contact our maintenance service department.

5. Technical Specification

Voltage	120V~	Max Vacuum	≥20kpa
Frequency	60Hz	Noise	≤76db (A)
Power Input	1200W		
Protection Class	Class II		

Dust DC Care®

DCC-2HD

HD
2
 Heavy Duty

Instruction Manual

COMMERCIAL



Please read manual carefully and keep for future reference.

Dust DC Care®

Division of B.V.C. Smyrna, GA 30082

Welcome to use our vacuum cleaner. You should read the manual before operation to make sure safety. Please keep the manual properly for reference later.

1. IMPORTANT SAFETY INSTRUCTIONS

READ ALL INSTRUCTIONS BEFORE USING

When using an electrical appliance, basic precautions should always be followed, including the following:

WARNING To reduce the risk of fire, electric shock, or injury:

1. Do not leave appliance when plugged in. Unplug from outlet when not in use and before servicing.
2. Do not use outdoors or on wet surfaces.
3. Do not allow to be used as a toy. Close attention is necessary when use by or near children.
4. Use only as described in this manual. Use only manufacturer's recommended attachments.
5. Do not use with damaged cord or plug. If the appliance is not working as it should, has been dropped, damaged, left outdoors, or dropped into water, return it to a service center.
6. Do not pull or carry by cord, use cord as a handle, close a door on cord, or pull cord around sharp edges or corners. Do not run appliance over cord. Keep cord away from heated surfaces.
7. Do not unplug by pulling on cord. To unplug, grasp the plug, not the cord.
8. Do not handle plug or appliance with wet hands.
9. Do not put any object into openings. Do not use with any opening blocked, keep free of dust, lint, hair, and anything that may reduce air flow.
10. Keep hair, loose clothing, fingers, and all parts of body away from openings and moving parts.
11. Turn off all controls before unplugging.
12. Use extra care when cleaning on stairs.
13. Do not use to pick up flammable or combustible liquids, such as gasoline, or use in areas where they may be present.
14. Do not pick up anything that is burning or smoking, such as cigarettes, matches or hot ashes.
15. The power cord utilizes a special connector. If the cord has to be repaired, you must go to a service center.
16. Do not use without dust bag and/or filters in place.
17. Connect to properly grounded outlet only. See Grounding Instructions.

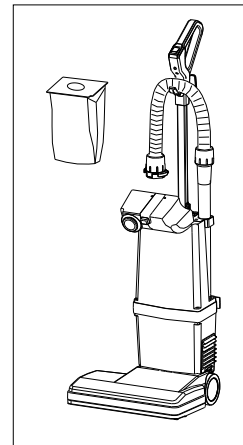

← When replacing the filter bag, open the dust cover and remove the bag. Replace the bag with an original factory supplied filter bag and close the cover. You may then continue cleaning.

Caution:

1. Make sure the machine is completely turned off before opening the cover.
2. Properly dispose of the dust bag.

B. Maintenance

Remove the filter from the bottom of the dust cover and rinse out with water for cleaning.

Allow filter to completely dry and then place

← back in the machine.

Caution:

1. The filter should be cleaned every 5-6 days, of use or more if needed.
2. Do not operate with the dust bag removed.
3. Check to make sure the dust bag has been installed correctly and that there is no damage to bag prior to use.
4. Make sure the machine is completely turned off prior to removing the dust bag to ensure no debris falls into the motor.

To replace the belt and/or clean the brush roll
Remove the screw with a screwdriver and turn knob to remove the bottom plate and take out the brush roll and belt for cleaning and maintenance.

← Caution:

1. The belt should be replaced if it is binding or is not working properly.
2. The brush roll needs to be cleaned and free of any debris or it will not work properly.
3. Make sure to unplug the machine prior to any maintenance on the belt or brush roll.

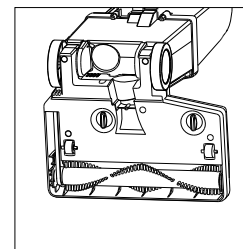
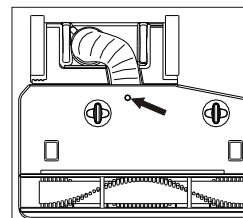
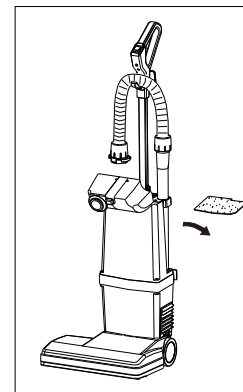

2. Part name and operation

A. Part name

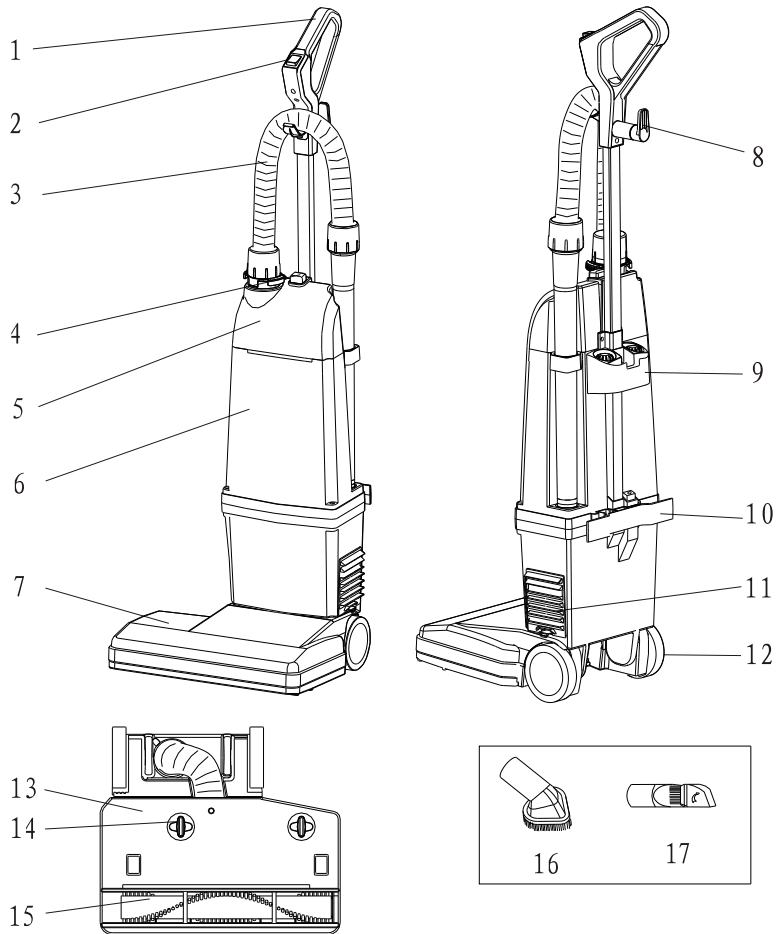

- | | | |
|----------------------|------------------------------|---------------|
| 1 Handle | 2 Power switch | 3 Hose |
| 4 Button of dust cup | 5 Dust cover | 6 Bag housing |
| 7 Motorized brush | 8 Quick release cord hook | 9 Handle |
| 10 Lower cord hook | 11 HEPA filter cover | 12 Wheel |
| 13 Bottom plate | 14 Bottom plate release knob | 15 Brush roll |
| 16 Dust brush | 17 Combination nozzle | |

B. Operation guidance

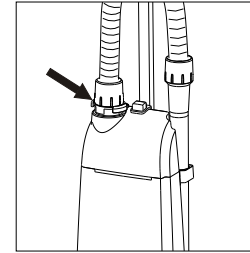

← Press the button on the hose cuff and take off the connector.

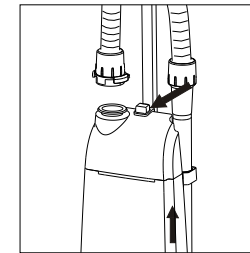

← Press the button of the dust cover as indicated in the left figure.

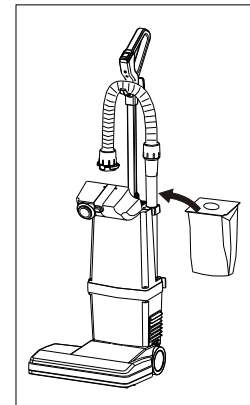

← Insert the dust bag into the bag housing. Make sure it is inserted correctly (see figure on left).

Caution: This model is equipped with a safety switch that won't allow the machine to work without a dust bag.

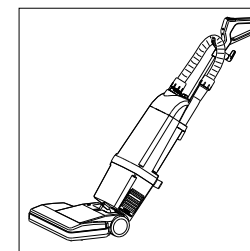

← Remove the power cord and plug the machine into the outlet. Pull down on the handle and turn on the machine at the power switch.